

# Large Angle Beam Transducers—North American Standards

## Types SWS and AWS

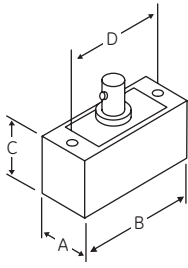

Element Size		A		B		C		D	
mm	in	mm	in	mm	in	mm	in	mm	in
13 Ø	.50 Ø	18.3	.72	25.4	1.00	19.1	.75	20.6	.81
13 x 25	.50 x 1.0	18.5	.725	38.4	1.51	19.1	.75	33.3	1.31
19 x 25	.75 x 1.0	25.4	1.00	38.1	1.5	19.1	.75	33.3	1.31
25 Ø	1.0	31.0	1.22	41.9	1.65	19.1	.75	35.1	1.38
16 x 16	.63 x .63	18.5	.73	31.8	1.25	19.1	.75	25.4	1.00
16 x 19	.63 x .75	18.5	.73	31.8	1.25	19.1	.75	25.4	1.00
19 x 19	.75 x .75	21.6	.85	31.8	1.25	19.1	.75	25.4	1.00



## Angle Beam Transducers—Types SWS and AWS

Freq. (MHz)	Element Ø		Order Codes					Freq. (MHz)	Element Ø		Order Codes				
			Gamma Series	Benchmark Series	Standard Wedge (W = 118-340)	Hi-Temp Wedge* (W = 118-340)	Accessories				Gamma Series	Benchmark Series	Standard Wedge (W = 118-340)	Hi-Temp Wedge* (W = 118-340)	Accessories
0.50	25	1.0	260-600		W-021 45°	W-081 45°	2.25 AWS Series	16 x 16	.63 x .63	292-603	892-603	W-104 45°			
					W-022 60°	W-082 60°						W-105 60°			
	13	0.5	241-600	841-600	W-023 70°	W-083 70°		W-106 70°							
					W-025 90°										
1.0	13 x 25	0.5 x 1	291-600	891-600	W-009 45°	W-076 45°	3.5	19 x 19	.75 x .75	292-604	892-604	W-104 45°			
					W-010 60°	W-077 60°						W-105 60°			
	19 x 25	.75 x 1	291-605	891-605	W-011 70°	W-078 70°		W-106 70°							
					W-013 90°										
2.25	13 x 25	0.5 x 1	292-600	892-600	W-015 45°	W-070 45°	5.0	13	.5	244-600	844-600	W-009 45°	W-076 45°		
					W-016 60°	W-086 60°						W-010 60°	W-077 60°		
	19 x 25	.75 x 1	292-605	892-605	W-017 70°	W-071 70°		W-011 70°	W-078 70°						
					W-019 90°			W-013 90°	W-078 70°						
5.0	19 x 25	.75 x 1	292-605	892-605	W-051 45°		5.0	19 x 25	.75 x 1	294-605	894-605	W-052 60°			
					W-052 60°							W-053 70°			
	25	1.0	262-600	862-600	W-053 70°			W-054 90°							
					W-054 90°										
2.25	13 x 25	0.5 x 1	292-600	892-600	W-021 45°	W-081 45°	5.0	25	1.0	264-600	864-600	W-022 60°	W-082 60°		
					W-022 60°	W-082 60°						W-023 70°	W-083 70°		
	19 x 25	.75 x 1	292-605	892-605	W-023 70°	W-083 70°		W-025 90°							
					W-025 90°										

\* Duty Cycle: at 400°F (200°C), maximum contact time is 10 seconds; cool to ambient before reuse. Note: Standard wedge angles are specified for carbon steel. Custom configurations are available by special order.